

Construction work for partition of Lab. in Mechanical workshop, NIT Manipur:

1. Plywood (6mm thickness) partition work for the specific area details given in plant layout (Ref. Flag I)

Note: Height of the Plywood wall = 7 ft.

Type-A Plywood wall (Ref. Flag I): Glass partition of 2 ft. between Plywood walls.

Type-B Plywood wall (Ref. Flag I): Full Plywood wall without glass partition.

2. Glass work in specific side of plywood wall (Type-A wall), details given in plant layout (Ref. Flag I)
3. Painting of plywood walls both sides.
4. Wooden columns and bars as per the plywood wall requirements.

Jashyad S.M.
06/02/19
MOD (M.E)

H. Durajan
06/02/19

D. Veow.
06/02/19

DETAILS OF REQUIRED WALL PARTITION IN MECH WORKSHOP

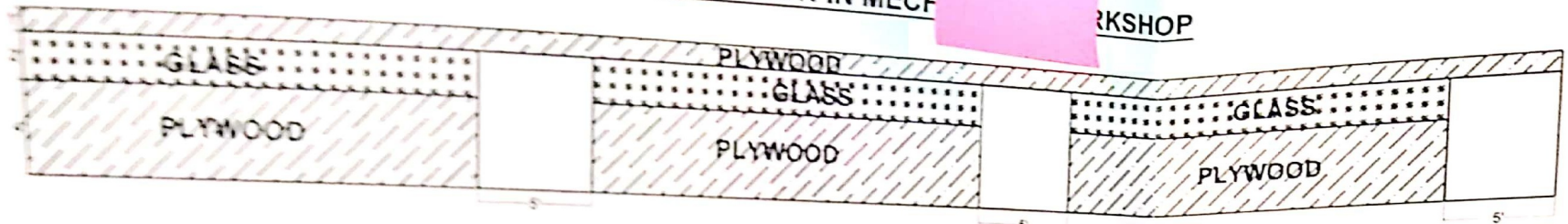

ELEVATION OF WALL TYPE -A (with glass)

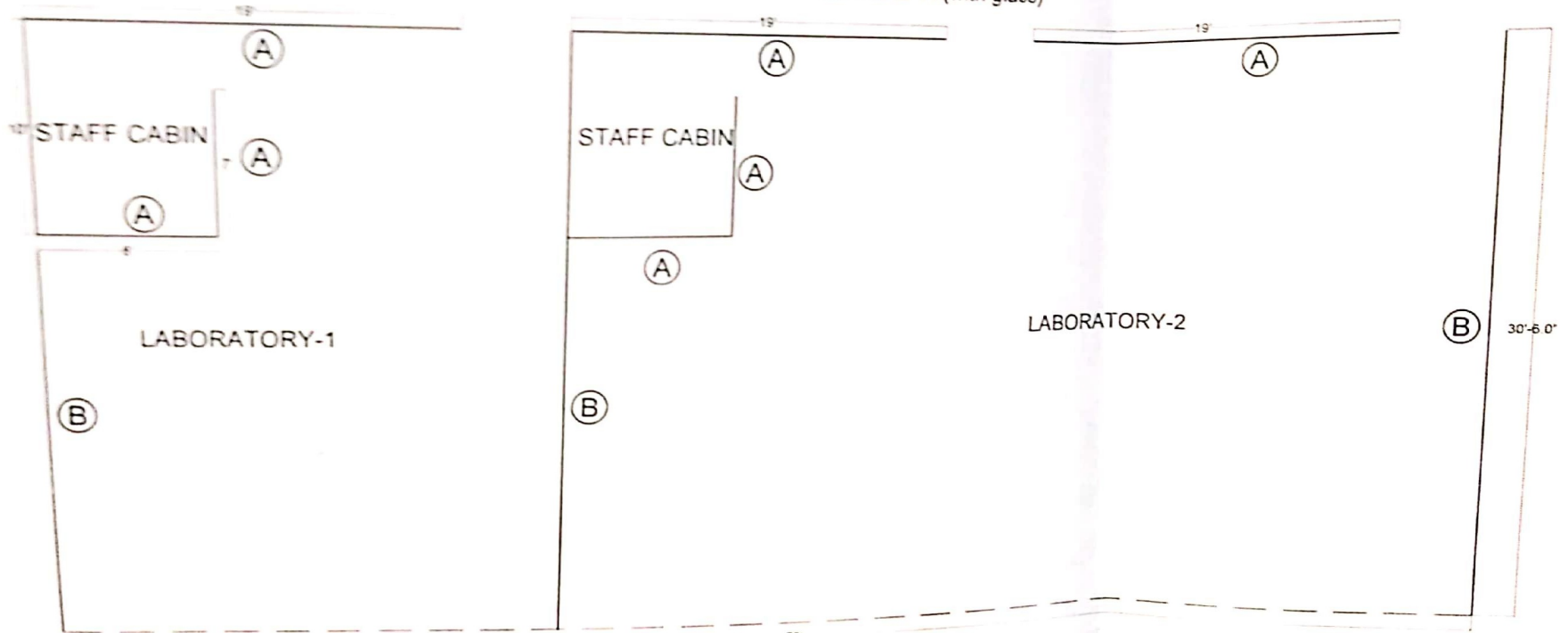

PLAN FOR LAB PARTITION

INDEX

Sl.no	LINE	REMARKS
1	---	WALL ALREADY MADE
2	---	REQUIRED WALL

PARTITION OF WALL IN MECHANICAL WORKSHOP	
All dimensions are in ft.	
SCALE 1:1	
Approved by :-	Drawn by :- LAISHRAM BIRJIT SINGH (Technical Assistant) DEPT. MECHANICAL ENGG. NIT MANIPUR

L. Velma
06/2/19

Jusheyat Sivi
06/02/19
HO D (CME)

H. Durajan
06/02/19